

P17H043D-AC-LC-SH

Liquid-Cooled Series™ Scroll Compressor

100% Oil-Free

Maintain the purity of your system with oil-free scroll technology

Semi-Hermetic Design

No dynamic seals with patented magnetic coupling configuration

Integrated Liquid Cooling

Effective heat dissipation and low discharge temperature

Efficient, High-Pressure Performance

Over 90% volumetric efficiency at high-pressure operation

Quiet and Smooth Operation

Dynamically balanced, valve-less, and nearly pulsation-free

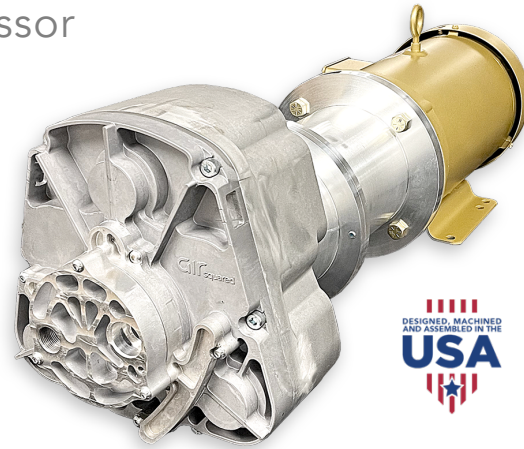

	SI	IMPERIAL
MAX. PRESSURE	13.1 bar _g	190 psi _g
VOLUME RATIO	3.64	
MAX. FLOW	425 lpm _v	15 cfm _v
DISPLACEMENT	134.5 cm ³ / Rev.	8.2 in ³ / Rev.
RATED SPEED	3,450 RPM	
RATED POWER	5.6 kW _e	7.5 hp _e
RATED CURRENT	16.8 A @ 230 V 18.5 @ 208 V 8.4 @ 460 V	
MOTOR	230 V / 460 V TEFC Three-Phase AC	
COOLING	Integrated Liquid Cooling <i>External Cooling Loop Required</i>	
AMBIENT TEMP. RANGE	-40 °C – 50 °C	-40 °F – 122 °F
NOMINAL SOUND LEVEL	69 dB(A)	
TOTAL PACKAGE WEIGHT	67 kg	148 lb
PORT CONFIGURATION	M22 x 1.5 (Working Fluid) 1" Fitting (Coolant)	
INGRESS PROTECTION	IP67 (Compressor)	
COMPLIANCE	RoHS, REACH, Buy America	
PART NUMBER	P17H043D-B10	

MEDIA COMPATIBILITY

Air, CO₂, CO, He, N, Ar, and Natural Gas are compatible with the standard product configuration.

H₂ and O₂ are compatible with an optional configuration.

AVAILABLE ACCESSORIES

Variable Frequency Drive

Multi-Compressor Skid

↳ Integrated Cooling Loop

OPTIONAL CONFIGURATIONS

Alternate Motor

OEM CONFIGURATIONS

Qualified OEMs should consult Air Squared for custom configurations and application-specific requirements.

Contact info@airsquared.com.

The information presented in this material is based on technical data and test results of nominal units. It is believed to be accurate and reliable. Air Squared does not warrant, guarantee, or assume liability in connection with this information. Picture, Performance, Dimensions, Coolant, and Electrical information for reference use only - visit airsquared.com for current specifications. Application conditions may adversely affect performance and product life. It is the responsibility of the user to determine the suitability of the product for intended use.

P17H043D-AC-LC-SH

Performance

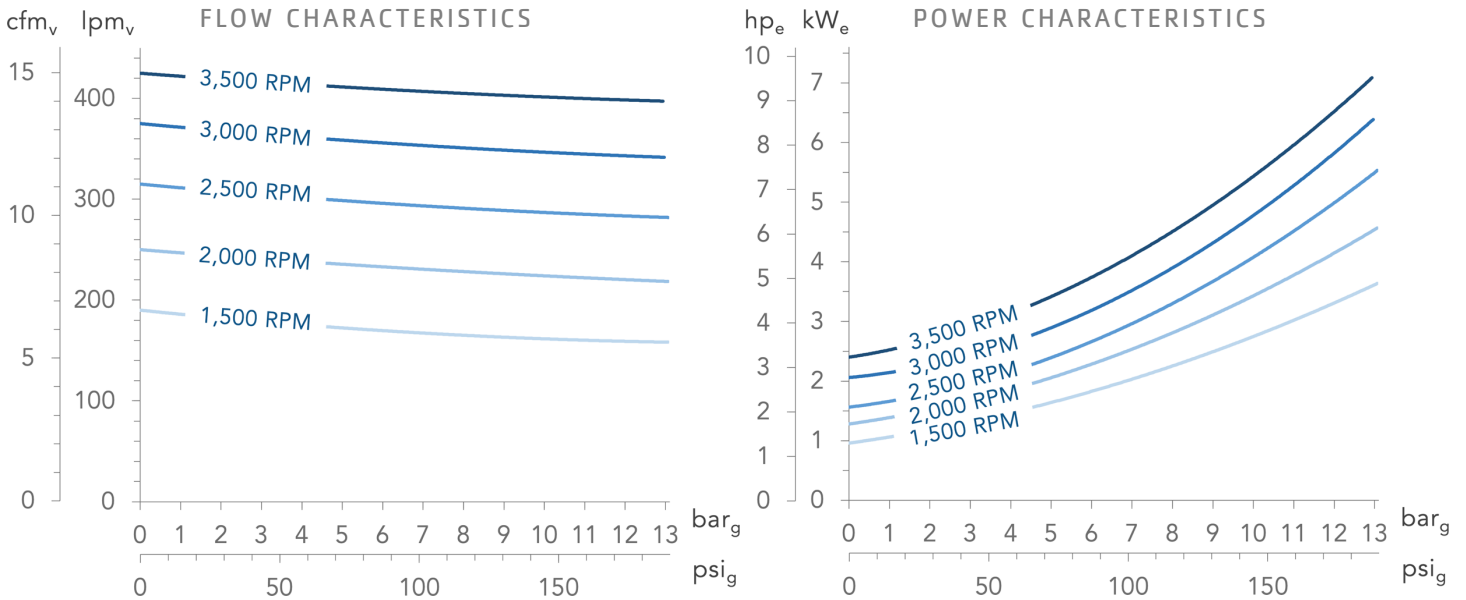

Flow Characteristics reflect nominal volume flow with air at NIST standard inlet conditions. Power Characteristics reflect nominal electric power consumption in Broomfield, CO USA with standard motor and controller losses.

Dimensions

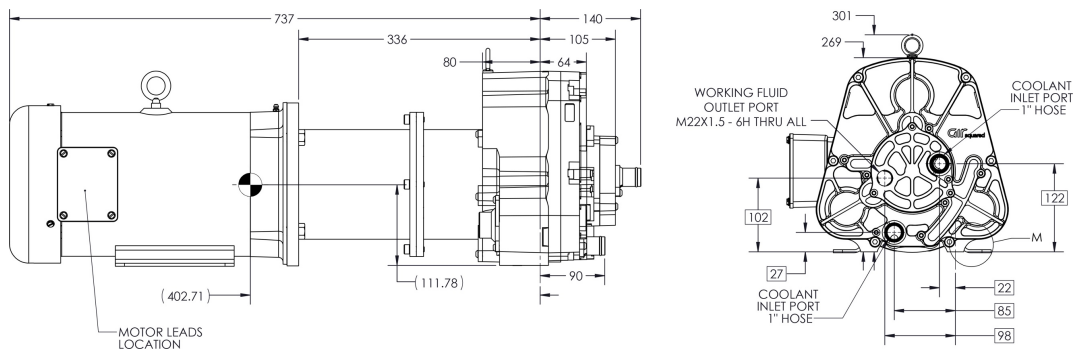

Dimensions in millimeters unless otherwise stated.

Cooling

	SI	IMPERIAL
MIN. COOLANT PRESSURE	0.7 bara	10 psia
MAX. COOLANT PRESSURE	4.1 bara	60 psia
COOLANT TEMP. RANGE	-20 °C – 55 °C	-4 °F – 131 °F
INTERNAL COOLING CHANNEL VOLUME	0.32 L	0.09 gal.
COOLANT TYPE	50% Glycol (Preferred), Other (Requires Corrosion Inhibitor)	
PORT CONFIGURATION (COOLANT)	1" Coolant Fitting	
COMPRESSOR COOLING	Integrated Liquid Cooling	

P17H043D-AC-LC-SH

Cooling

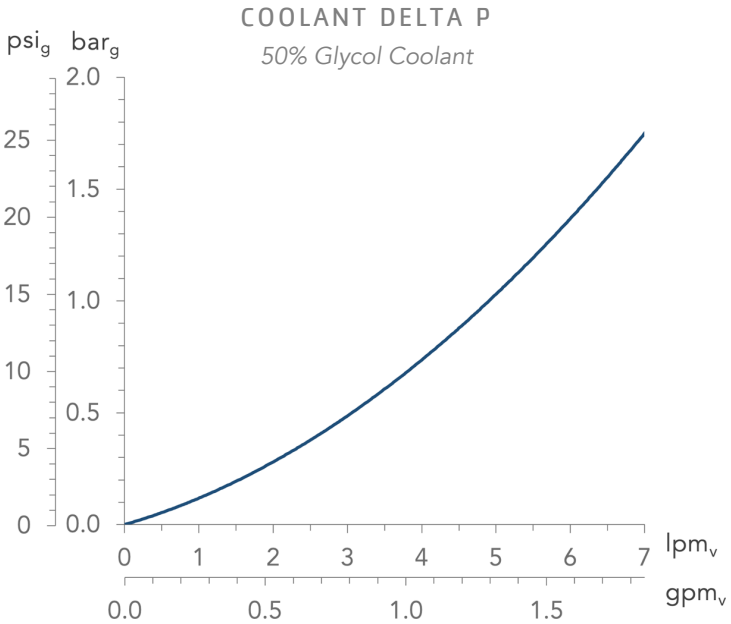
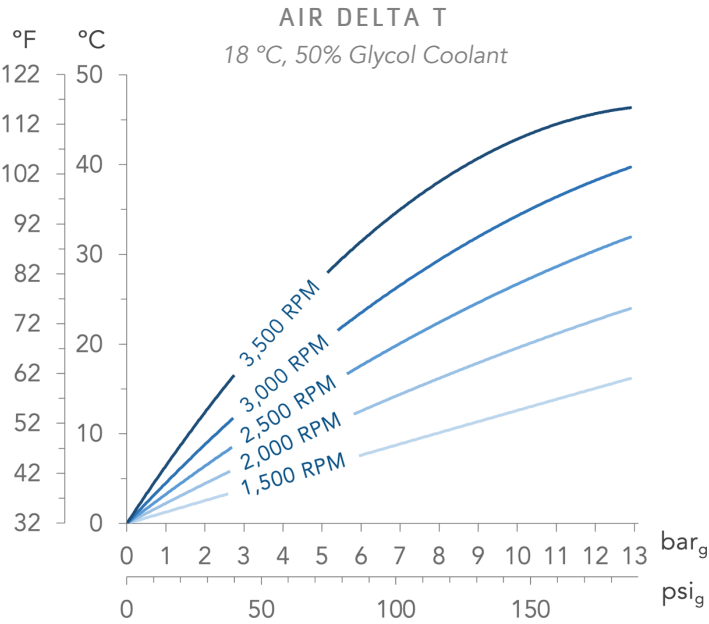
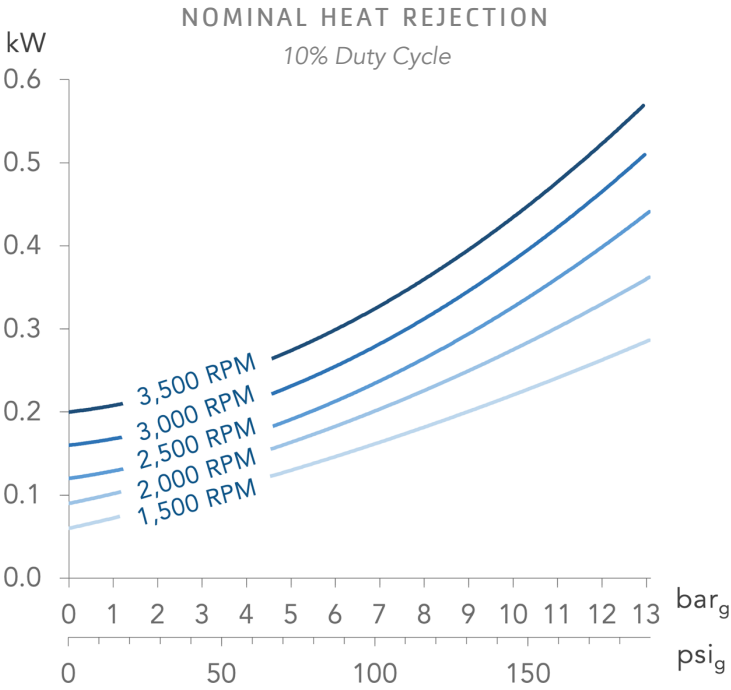
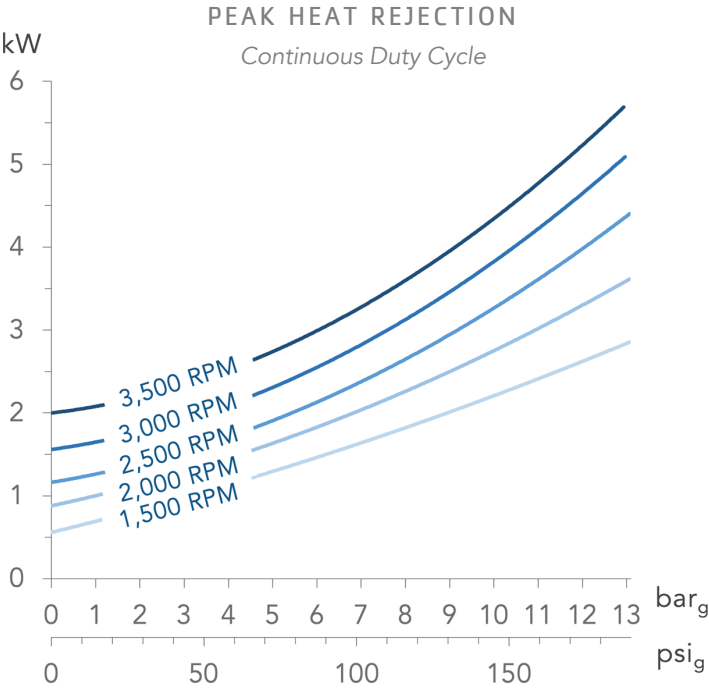

Learn More About Oil-Free Scroll Technology at <http://airsquared.com>